



# CITY OF CITRUS HEIGHTS

## BUILDING DEPARTMENT

Technical Bulletin

6237 Fountain Square Drive \* Citrus Heights, Ca. 95621-5577

(916) 727-4760 \* Inspections (916) 727-4750 \* [www.ci.citrus-heights.ca.us](http://www.ci.citrus-heights.ca.us)

The City of Citrus Heights is committed to providing high quality, economical responsive services to our community.

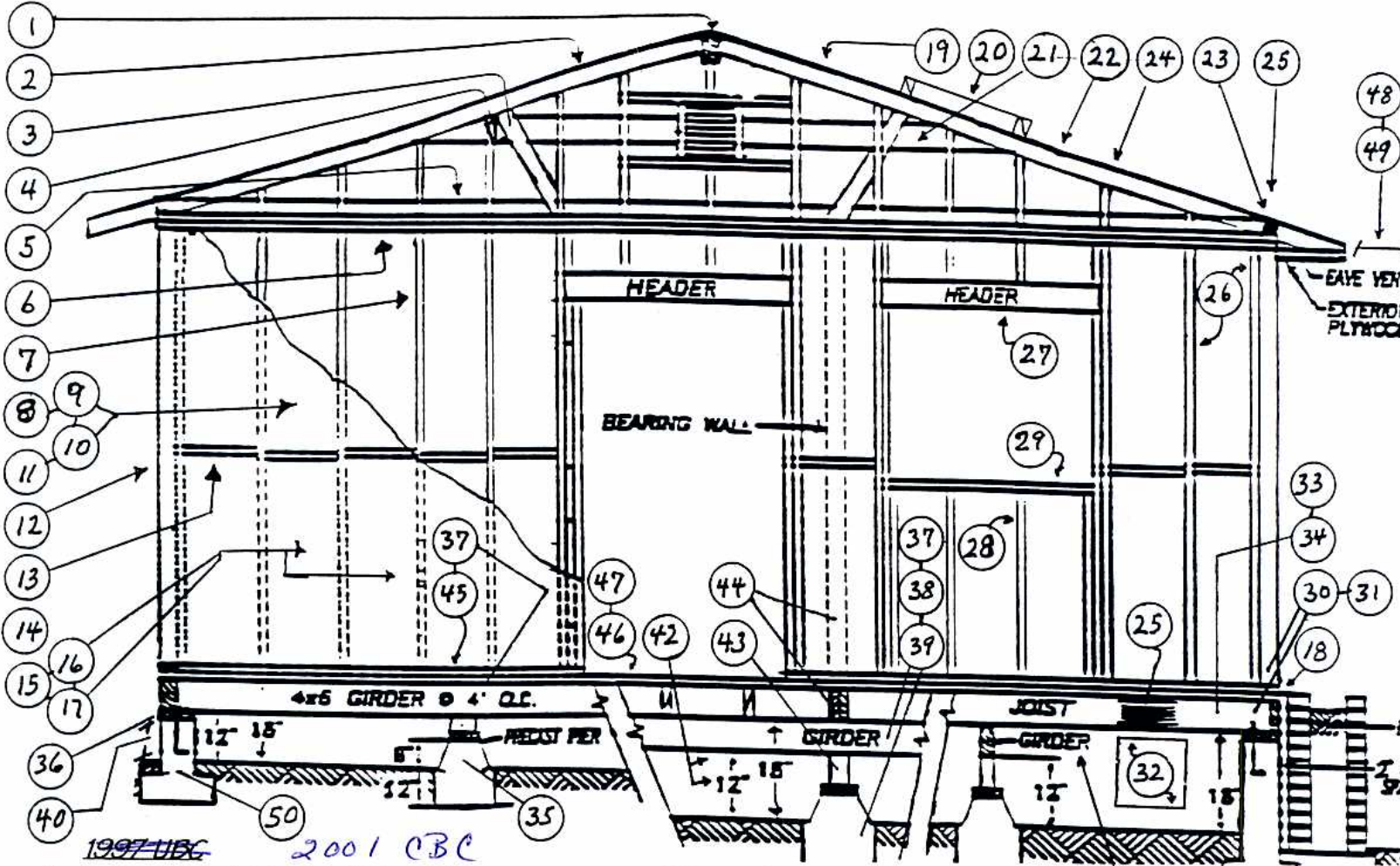

1997 IBC 2001 CBC

- |  |                       |   |           |
|--|-----------------------|---|-----------|
| 1) Rafter to ridge full bearing (1" Min ridge)                         | 2320.12.3             | 27) See header span chart                                     | local     |
| 2) Rafter span   | CHBD-span table       | 28) Cripple same as layout/ 16" oc                            | standard  |
| 3) Strut to purlin 45° max from Vert. To bearing wall/FND              | 2320.12.7             | 29) Sill height @ bedrooms finished 44" max                   | 310.4     |
| 4) Purlin, 2x4-4' span, 2x6-6' span max for ail                        | 2320.12.7             | 30) Sill plate nail (all) 16" oc -16d                         | 2311B1    |
| 5) Ceiling joist' (L/240)  | CHBD-span table       | 31) Sill plate on FND- 2"x2"x3/16 washer                      | 1806.6.1  |
| 6) Top plate, bearing wall, double all, 48" lap, 16d 16"oc             | 2320.11.2             | 32) Under floor access 18"x24", 20' max from cleanout         | 2306.3    |
| 7) Stud sizing-height-space-, 8' max utility grade, 10' max others     | 2320.11.1             | 33) Joist blocking, >10' oc -full depth-full rim joist        | 2320.8.3  |
| 8) Brace wall-25'oc panel-4'x8' x 3/8 @ 24"oc-block all edges          | 2320.11.3*            | 34) Floor load 1/360, 40 LL-10 DL, balcony 60#                | local/TBL |
| 9) Brace wall-25'oc panel-4x8 x 5/16 @ 16"oc- "                        | 2320.11.3*            | 35) Pier footing 14" x 14" x 12" deep, 8" above earth         | 2306.5    |
| 10) All brace walls require top/bottom/all edges 6"oc, 12"oc field     | 2311B1.27*            | 36) FND plates/sills- PT or reawood sill rated                | 2320.6    |
| 11) Brace panels not to be cut along face                              | industry standard     | 37) Girders, 4x6 min, structural grade, 1 story only          | 2320.7    |
| 12) Corner studs-3 min, or (see exceptions)                            | 2320.11.2             | 38) Girders span, pier 6' oc, 8' oc layout                    | 2320.7    |
| 13) Per 10' max ht in wall, typical 2 story balloon frame              | 2320.11.8             | 39) Girders bearing, 1/2" wood, 3' masonry, 1/2" air gap      | 2320.8.2  |
| 14) King stud with 1 trimmer bearing 1-1/2"<8", 2 story Dbl >6'        | 2320.11.6             | 40) Wood to earth separation 6",                              | 2306.8    |
| 15) Ext. 5/8 siding-t-111 existing only, 6" eage, 12" field, 8d, galv. | 2310.2 lcl            | 41) Column/post on slab, 6" min separation                    | 2306.5    |
| 16) Horizontal siding, galvanized 10d @ 1-1/2" penetration             | 2310.2 local          | 42) Floor joist clearance 18"- girder 12" from earth          | 2306.3    |
| 17) Veneer 5' thick, 15# sq ft max, ht unlimited, 1" air gap           | 2320.4.3              | 43) Post to girder gusset/mechanical connection               | standard  |
| 18) <6" requires 26 gu sheet metal                                     | 2306.8                | 44) Double floor joist at all bearing load paths              | 2320.8.5  |
| 19) Notching/cutting rafters or joist-enas 25%, 1/6 @ 1/3 span         | 2320.12.4             | 45) Plank T&G flooring, 2x6" min, 2-16d each joist            | 2320.9.3  |
| 20) Roof openings, >4' dbl trimmer/header-> 6" requires rangers        | 2320.12.5             | 46) Wood panel flooring, #10d @ 6" eage-12"oc field, 12" glue | 2320.9.3  |
| 21) Rafter tie 4' oc, 1 x material min.- lowest point                  | 2320.12.6             | 47) Panel 4'x8'-3/4" flooring, 16"oc joist, 7/8"-1" @ 24 oc   | TBL2311F1 |
| 22) Roof sheathing/deck-15/32 min OSB .. 4-ply min. other              | 2320.12.9             | 48) Eave-window-30" min from property line inc gutter         | 120+      |
| 23) Roof zone-eave block, complete parameter, 6" eage-12" oc field     | 2311B2.E2             | 49) Without window 36" min (see planning acct 5')             | TBL 5-4   |
| 24) Roof zone-nailing pattern 6" edge, 12" oc field                    | 2320.12.8/TBL-2311E.2 | 50) See Foundation Details                                    |           |
| 25) Provide 1/150 sq ft attic ventilation-unaerpin vent                | 1505.3/2306.7         |   |           |
| 26) Stud notch/boring, (N=25.40%)-(B=40-60%) NB vrs Brq                | 2320.11.10            |   |           |